

STANDOFFS ET SUPPORTS POUR ÉTAGÈRES ET VITRES / STANDOFFS, SHELF AND GLASS SUPPORTS

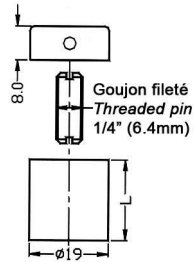

# QUINKO-TEK	DIMENSIONS DIMENSIONS	FINI FINISH	MATÉRIEL MATERIAL	CAISSE CASE
BF3119 - 02 / 19MC	D = 19 mm H = 19 mm	Nickel brossé <i>Brushed Nickel</i>	Métal / <i>Metal</i>	30
BF3119 - 02 / 25.4MC	D = 19 mm H = 25.4mm	Nickel brossé <i>Brushed Nickel</i>	Métal / <i>Metal</i>	30
BF3119 - 02 / 50MC	D = 19 mm H = 50 mm	Nickel brossé <i>Brushed Nickel</i>	Métal / <i>Metal</i>	20
BF3119 - 02 / 102MC	D = 19 mm H = 102 mm	Nickel brossé <i>Brushed Nickel</i>	Métal / <i>Metal</i>	12

Aussi disponible dans les finis suivants : CH = Chrome; BSS = Inox satiné; LT = Laiton
Also available in these finishes: CH = Chrome; BSS = Satin Stainless Steel; LT = Brass

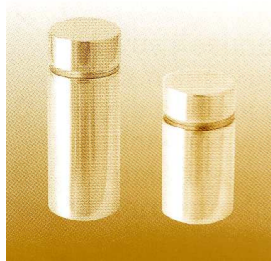
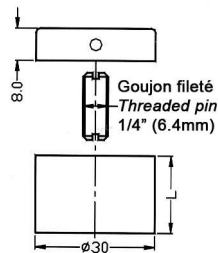

BF3130 - 02 / 19MC	D = 30 mm H = 19 mm	Nickel brossé <i>Brushed Nickel</i>	Métal / <i>Metal</i>	30
BF3130 - 02 / 25.4MC	D = 30 mm H = 25.4mm	Nickel brossé <i>Brushed Nickel</i>	Métal / <i>Metal</i>	30
BF3130 - 02 / 50MC	D = 30 mm H = 50 mm	Nickel brossé <i>Brushed Nickel</i>	Métal / <i>Metal</i>	20
BF3130 - 02 / 102MC	D = 30 mm H = 102 mm	Nickel brossé <i>Brushed Nickel</i>	Métal / <i>Metal</i>	12

Aussi disponible dans les finis suivants : CH = Chrome; BSS = Inox satiné; LT = Laiton
Also available in these finishes: CH = Chrome; BSS = Satin Stainless Steel; LT = Brass



8910PC - SUP	-	Chrome poli <i>Polished chrome</i>	Zamac	200
7990SC - SUPPS / P	-	Chrome satiné <i>Satin chrome</i>	Zamac	200